

### UNDERCOUNTER SINK

# K-3336, K-14300

#### FEATURES

- 13-3/4" (34.9cm) x 15-3/8" (39.1cm)
- 18 gauge stainless steel
- Undercounter
- Single compartment
- Rounded bowl
- Includes installation hardware

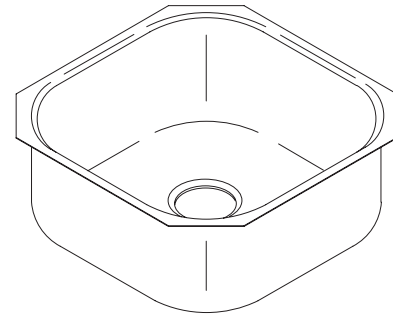

#### CODES/STANDARDS APPLICABLE

Specified model meets or exceeds the following:

- IAPMO/UPC
- State of Massachusetts

#### COLORS/FINISHES

- SBV Satin Bronze
- NA None Applicable

##### Accessories:

- CP Polished Chrome
- 0 White
- Other Refer to Price Book for additional colors
- NA None Applicable

#### SPECIFIED MODEL:

Model	Description	Colors/Finishes
K-3336	Undercounter kitchen sink	<input type="checkbox"/> NA
K-14300	Undercounter entertainment sink	<input type="checkbox"/> SBV

Optional Accessories			
K-3278	Hardwood cutting board	<input type="checkbox"/> NA	
K-3291	Colander	<input type="checkbox"/> 0 White	<input type="checkbox"/> Other_____
K-8801	Duostrainer sink strainer	<input type="checkbox"/> CP	<input type="checkbox"/> Other_____

#### PRODUCT SPECIFICATION:

The undercounter sink shall be 13-3/4" (34.9cm) in length, and 15-3/8" (39.1cm) in width. Sink shall be made of 18 gauge stainless steel. Sink shall be single compartment with rounded bowl. Sink shall include installation hardware. Sink shall be Kohler Model K-\_\_\_\_\_-\_\_\_\_\_-\_\_\_\_\_.

# UNDERTONE™

## PRODUCT INFORMATION

Fixture*:		basin area	water depth
Sink		14" (35.6cm) x 15" (38.1cm)	7-1/2" (19.1cm)
Outlet	3-5/8" D. (9.2cm)		
* Approximate measurements for comparison only.			
Included Components:			
Hardware kit			91915
Cutout template			113197

## INSTALLATION NOTES

\*Allow clearance around sink rim for clip attachment.

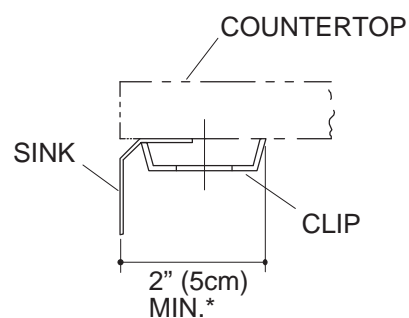
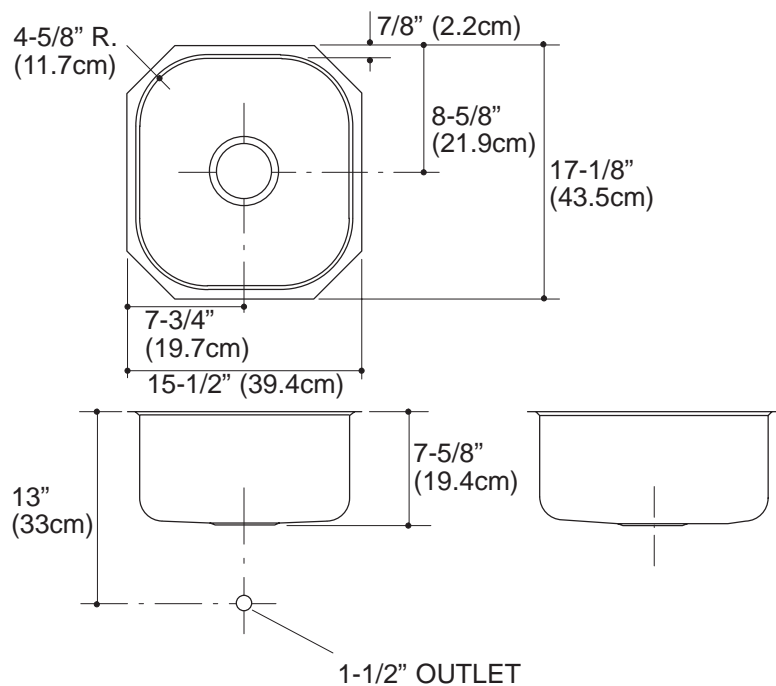

## PRODUCT DIAGRAM